



SLIDING AUTOMATIC ENTRANCES: THRESHOLD OPTIONS DURA-STORM™ 2000/3000

2.50 - THRESHOLD OPTIONS

- 2.50.01 - 2000 THRESHOLD OPTIONS
- 2.50.02 - 3000 THRESHOLD OPTIONS, SURFACE
- 2.50.03 - 3000 THRESHOLD OPTIONS, RECESSED



DURA-STORM 2000/3000 SERIES

THRESHOLD OPTIONS	
PROJECT INFORMATION	
PROJECT NAME:	
LOCATION:	
DOOR NUMBER(S):	
DATE:	SHEET: OF

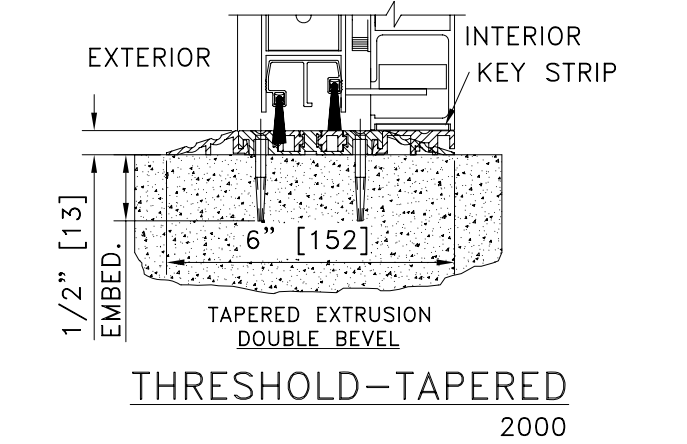
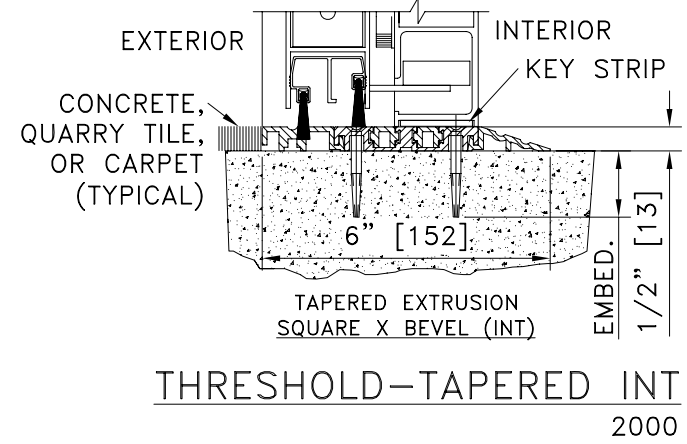
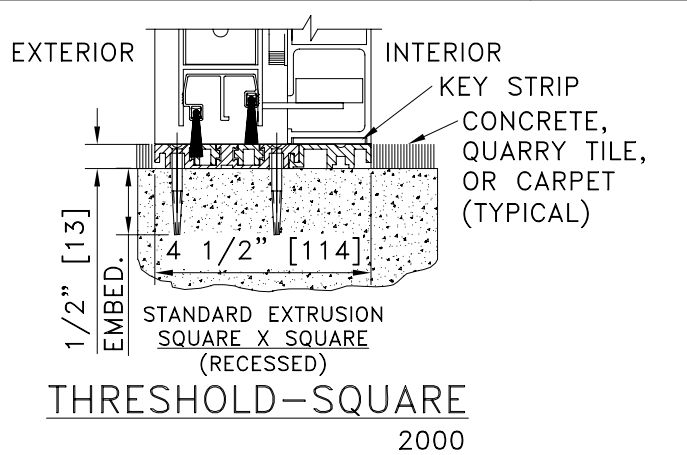
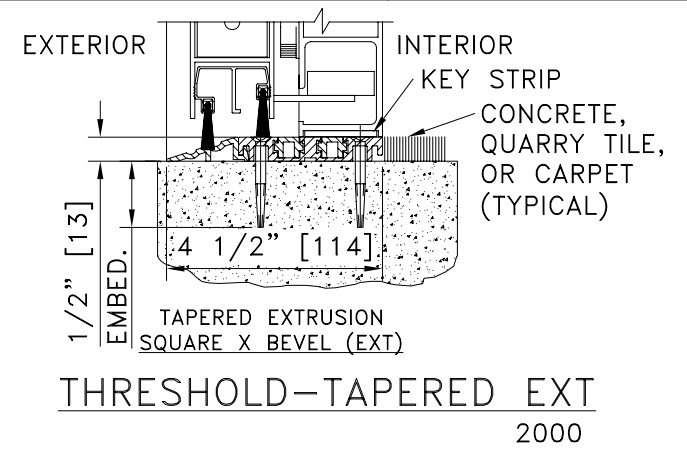

DURA-STORM 2000 SERIES 4 1/2" FRAME
SCALE: 3" = 1'-0"

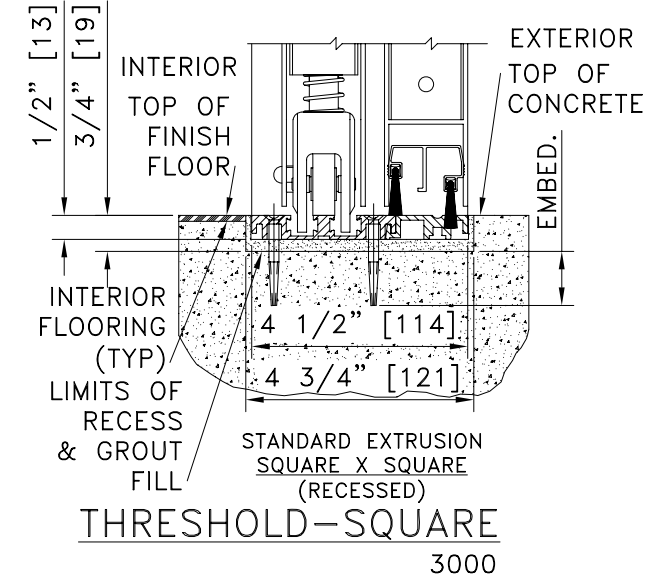
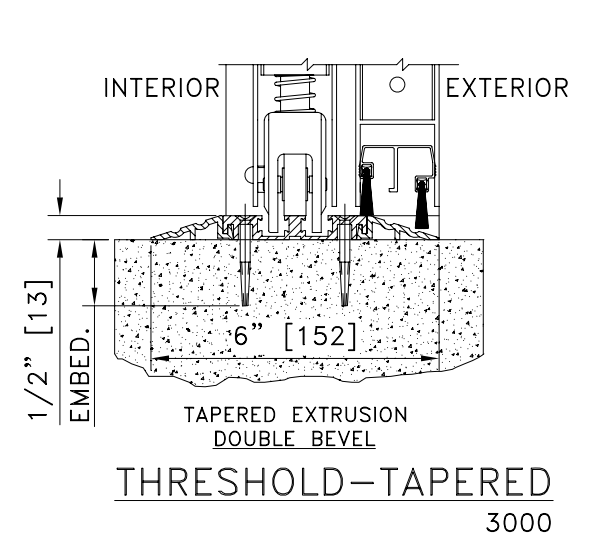
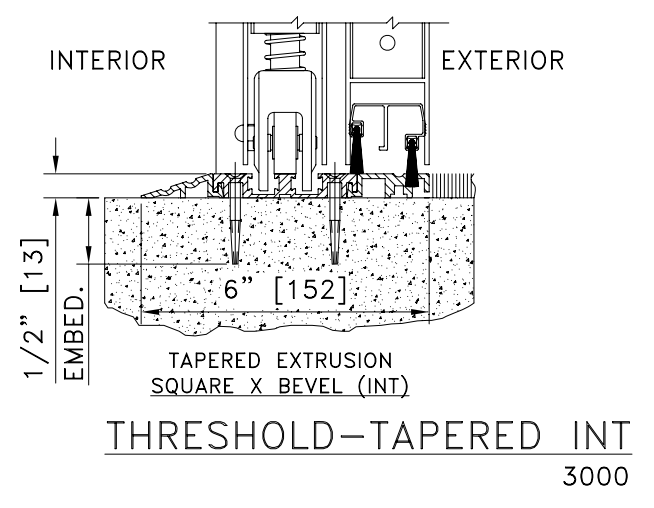
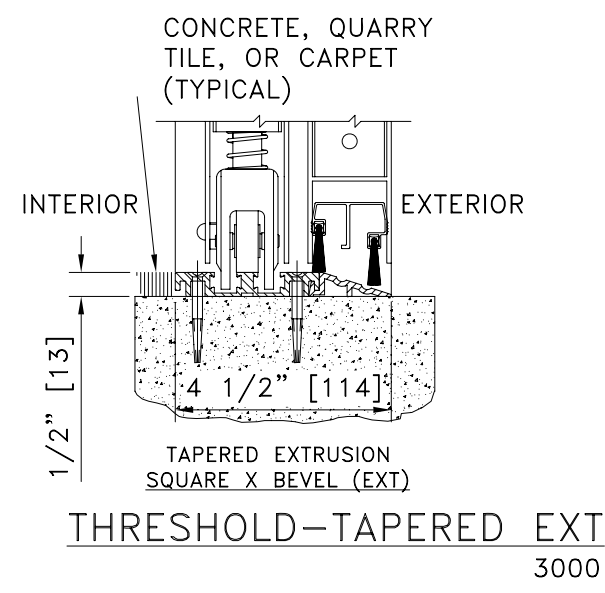

DURA-STORM 3000 SERIES 4 1/2" FRAME
SCALE: 3" = 1'-0"

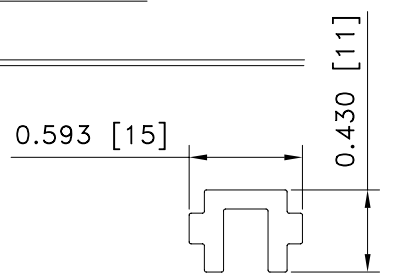

- NOTES:**
- RECESS SHALL BE 3/4" IN DEPTH BY 4 3/4" WIDE AND SHALL EXTEND FULL WIDTH OF ROUGH OPENING FOR CONTINUOUS THRESHOLDS OR UNDER "SO" PANELS ONLY FOR SEAMLESS FLOOR CONDITION AT DOOR OPENING.
 - FOR CONTINUOUS OPTION, THRESHOLD SHALL BE SPLIT AS REQUIRED TO FACILITATE MAINTENANCE OF THRESHOLD SECTION AT DOOR OPENING.
 - FILLER STRIP IS REQUIRED TO FILL SLOTS IN CONTINUOUS THRESHOLD THROUGHOUT DOOR OPENING.

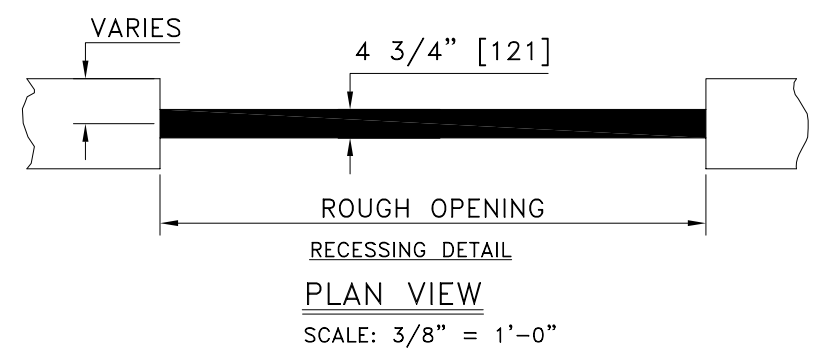

DURA-STORM 2000/3000 SERIES RECESSING DETAIL
SCALE: AS NOTED

- NOTES:**
- SEE MIAMI-DADE COUNTY NOTICE OF ACCEPTANCE FOR DETAILED ANCHORING REQUIREMENTS.

THRESHOLD OPTIONS	
DURA-STORM 2000/3000 SERIES	STANLEY Security ACCESS TECHNOLOGIES

**DURA-STORM
2000
SERIES**

PROJECT NAME: _____
 LOCATION: _____
 DOOR NUMBER(S): _____
 DATE: _____ SHEET: _____ OF _____

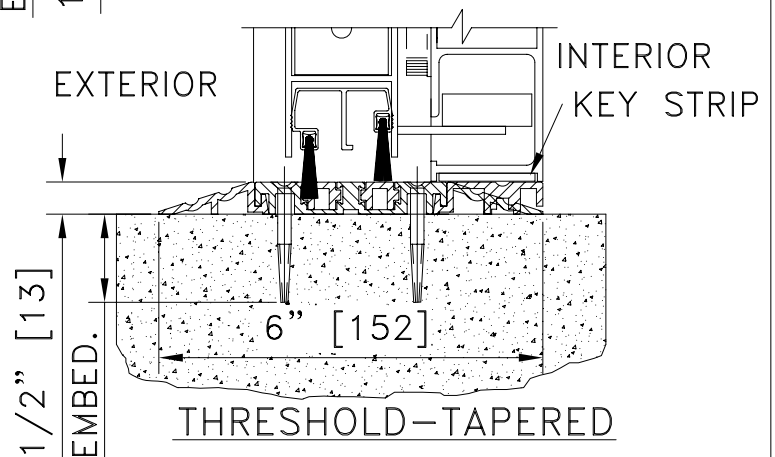
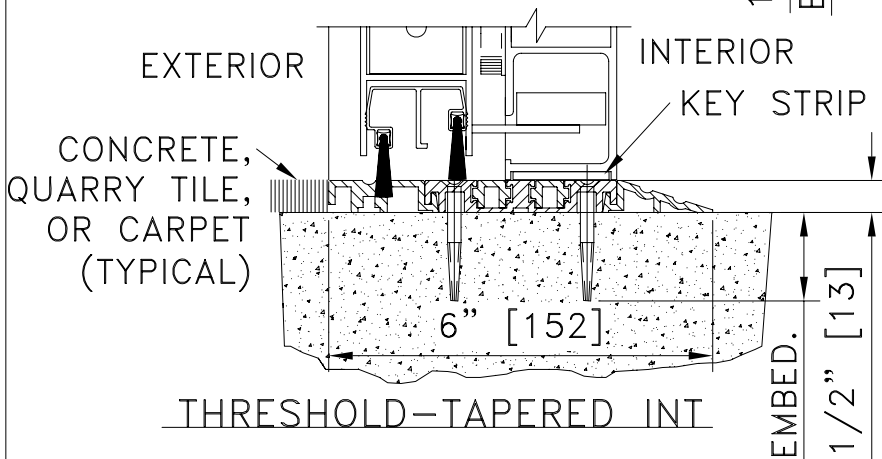
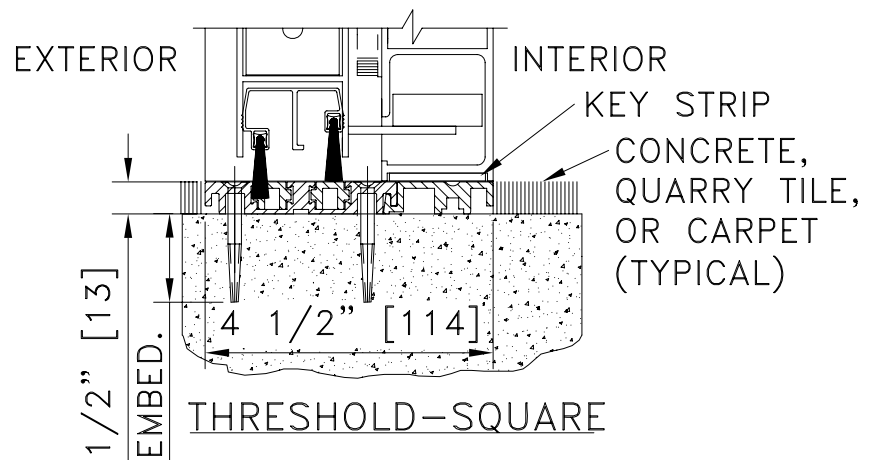
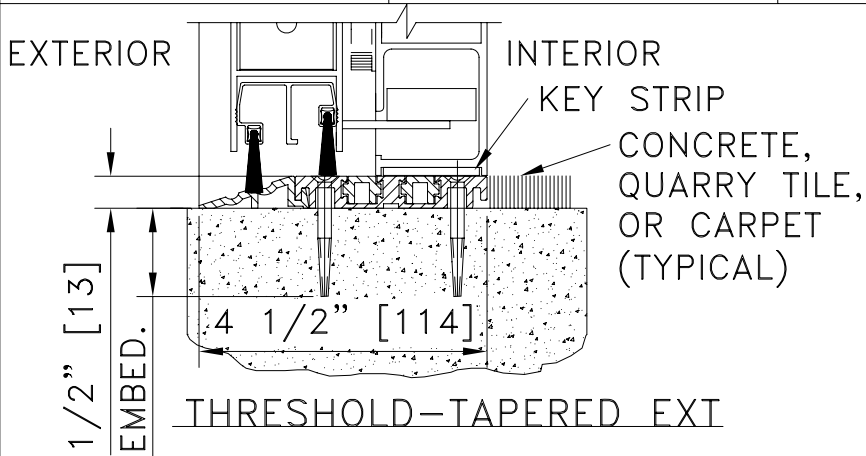

NOTES:
 1. SEE MIAMI-DADE COUNTY NOTICE OF ACCEPTANCE FOR DETAILED ANCHORING REQUIREMENTS.

CONCRETE, QUARRY
TILE, OR CARPET
(TYPICAL)

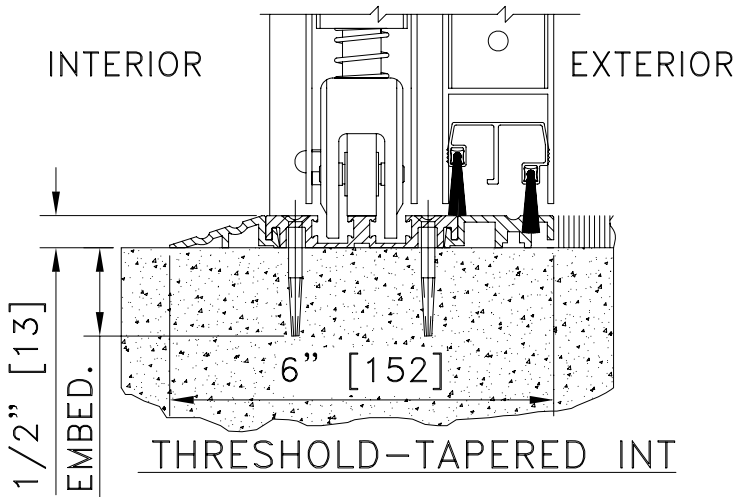
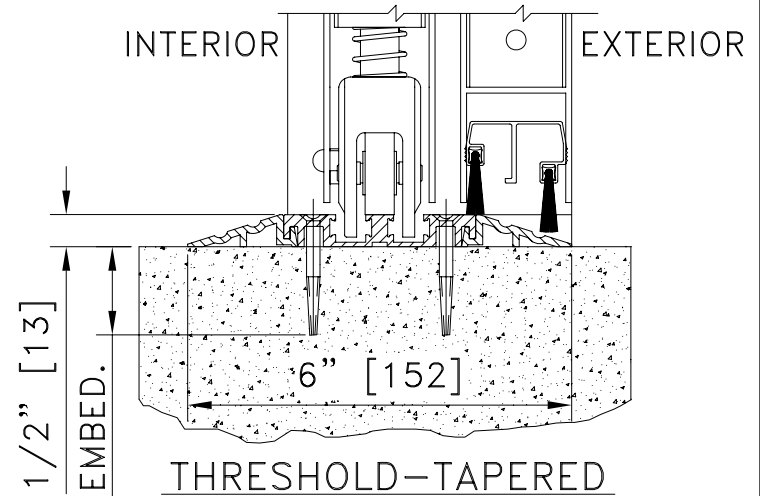
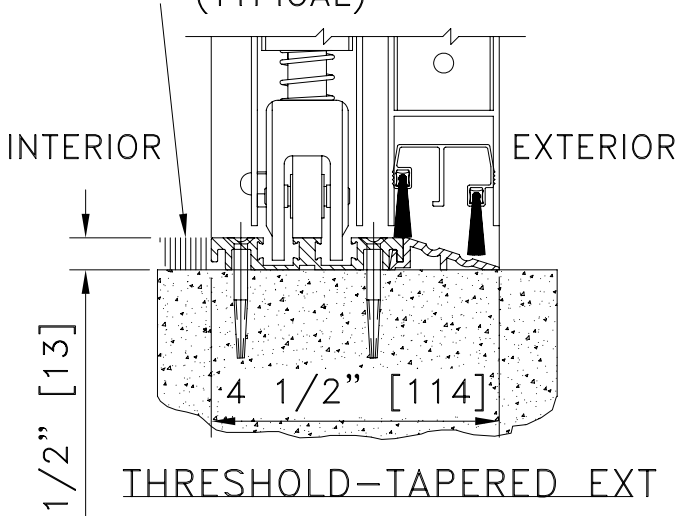

NOTES:

1. SEE MIAMI-DADE COUNTY NOTICE OF ACCEPTANCE FOR DETAILED ANCHORING REQUIREMENTS.

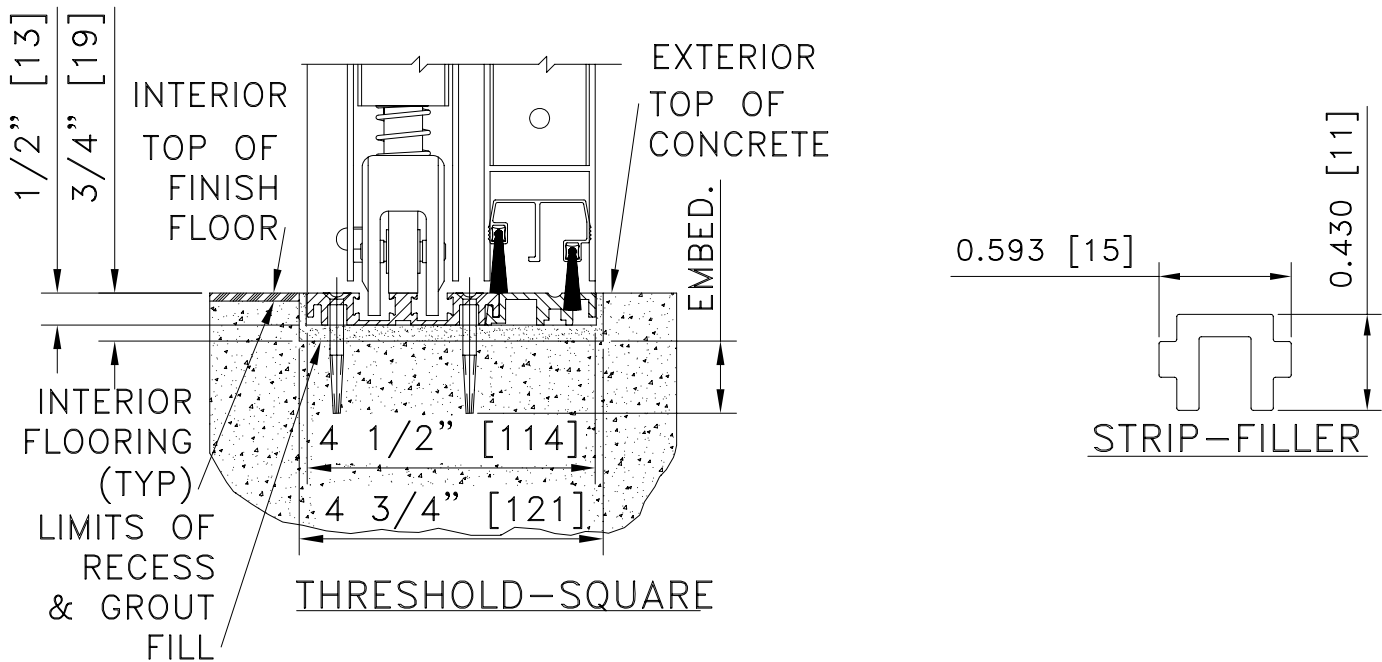

NOTES:

1. RECESS SHALL BE 3/4" IN DEPTH BY 4 3/4" WIDE AND SHALL EXTEND FULL WIDTH OF ROUGH OPENING FOR CONTINUOUS THRESHOLDS OR UNDER "SO" PANELS ONLY FOR SEAMLESS FLOOR CONDITION AT DOOR OPENING.
2. FOR CONTINUOUS OPTION, THRESHOLD SHALL BE SPLIT AS REQUIRED TO FACILITATE MAINTENANCE OF THRESHOLD SECTION AT DOOR OPENING.
3. FILLER STRIP IS REQUIRED TO FILL SLOTS IN CONTINUOUS THRESHOLD THROUGHOUT DOOR OPENING.

