

STANLEY

GLASS STOP EXTRUSION OPTIONS

**DURA-GLIDE
2000**

1/4" GLASS

HORIZONTAL

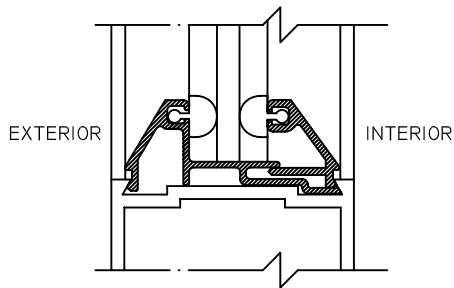

**GUTTER-BEVELED EXTRUSION
(RUNS HORIZONTALLY)**

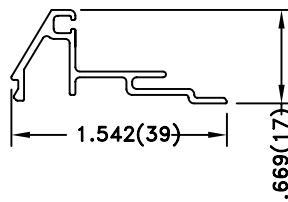

**GUTTER-BEVELED
EXTRUSION**

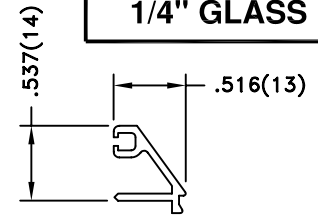

**GLASS STOP-BEVELED
EXTRUSION**

VERTICAL

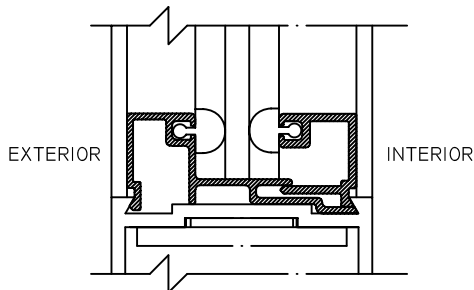

**GUTTER EXTRUSION
(RUNS VERTICALLY)**

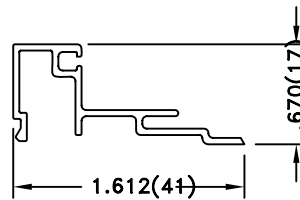

**GLASS STOP-GUTTER
EXTRUSION**

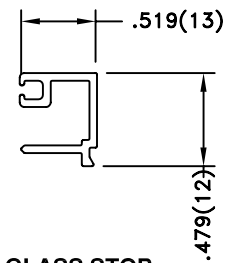

**GLASS STOP
EXTRUSION**

5/8" GLASS

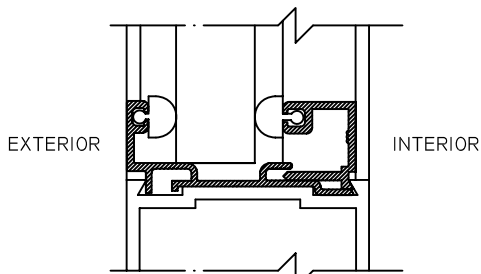

**GLASS STOP
ASSEMBLY**

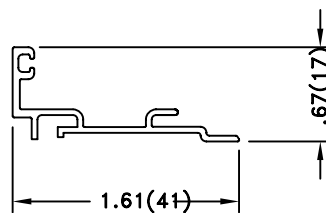

**GLASS STOP-GUTTER
EXTRUSION**

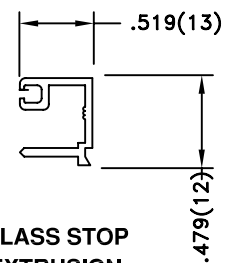

**GLASS STOP
EXTRUSION**

1" GLASS

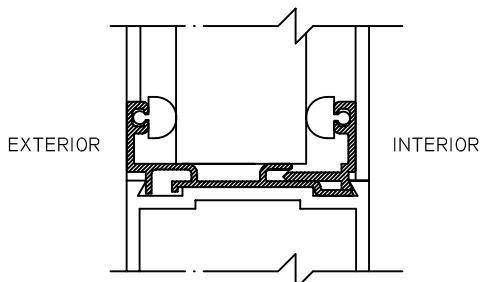

**GLASS STOP
ASSEMBLY**

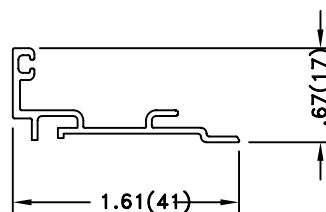

**GLASS STOP-GUTTER
EXTRUSION**

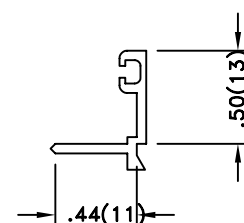

**GLASS STOP
EXTRUSION**

MEDIUM STILES AFFECT EVERY FORMULA FOR ANY GIVEN PACKAGE.
LISTED BELOW ARE FORMULAS RELATED TO MEDIUM STILE DOOR PACKAGES ONLY.

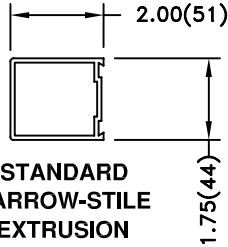

STANDARD NARROW-STILE EXTRUSION
("0" PANEL STILE EXTRUSION SHOWN)

SINGLE SLIDE - MEDIUM STILE

PACKAGE WIDTH = 2X CLEAR DOOR OPENING + 17 3/4"
CLEAR DOOR OPENING = 1/2 PACKAGE WIDTH - 9 3/8"
EMERGENCY BREAKOUT WIDTH = CLEAR DOOR OPENING + 5 1/8"
DOOR PANEL WIDTH = 1/2 PACKAGE WIDTH + 1/4"

BI-PART MEDIUM STILE

PACKAGE WIDTH = 2X CLEAR DOOR OPENING + 32 1/16"
CLEAR DOOR OPENING = 1/2 PACKAGE WIDTH - 16 1/16"
EMERGENCY BREAKOUT WIDTH = CLEAR DOOR OPENING + 10 1/4"
DOOR PANEL WIDTH = 1/4 PACKAGE WIDTH + 1 1/16"

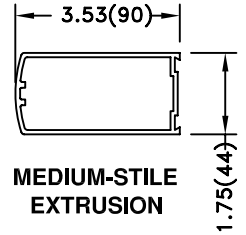

MEDIUM-STILE EXTRUSION

NOTE: MEDIUM STILE DOOR PACKAGE HAS SAME TOP AND BOTTOM RAILS AS SHOWN IN TYPICAL NARROW STILE VERTICAL SECTION.

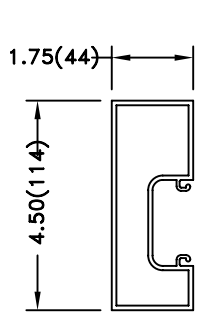

STANDARD JAMB-4 1/2"

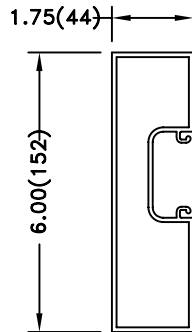

JAMB-6"

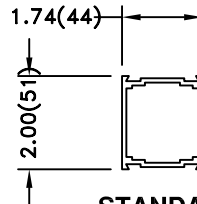

STANDARD 2" MUNTIN BAR

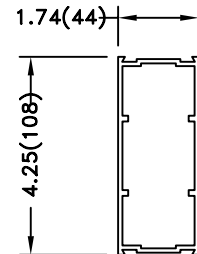

4 1/4" EXTRUSION MUNTIN BAR

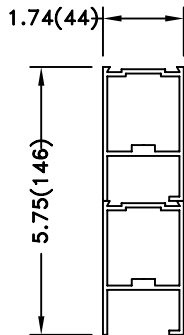

6" NOMINAL MUNTIN BAR

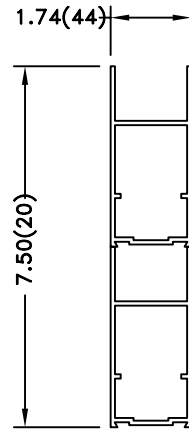

8" NOMINAL MUNTIN BAR

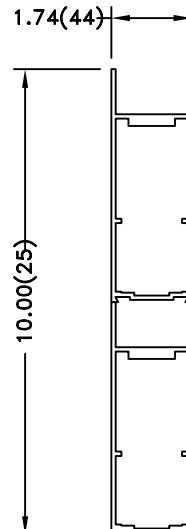

10" NOMINAL MUNTIN BAR

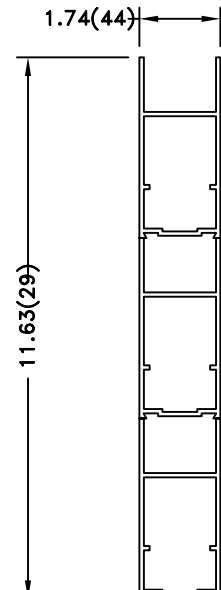

12" NOMINAL MUNTIN BAR

NOTE: TOP RAIL AND STANDARD DIMENSIONS DO NOT VARY. FOR OPTIONAL BOTTOM RAILS SEE APPENDIX 1.1.D.

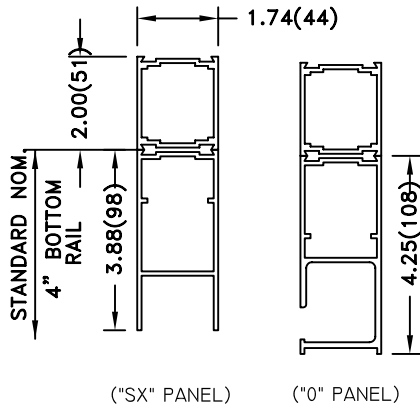

6"

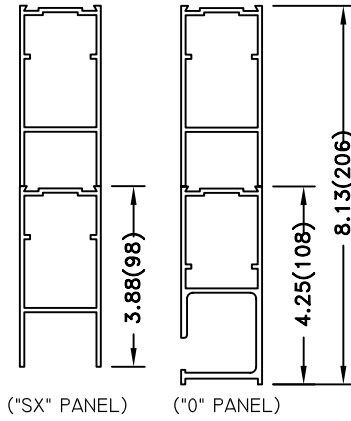

NOMINAL 8"

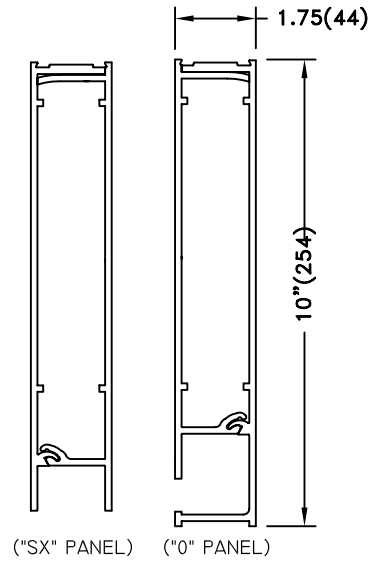

10" SEAMLESS

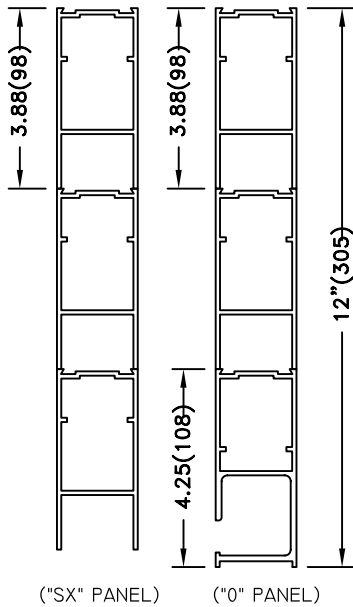

12"

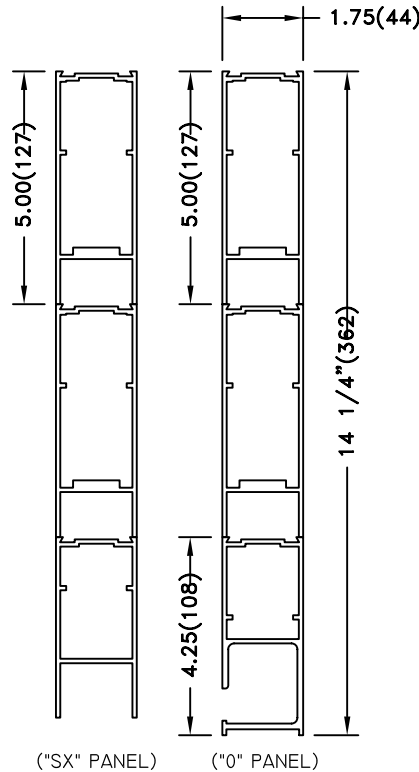

NOMINAL 15"

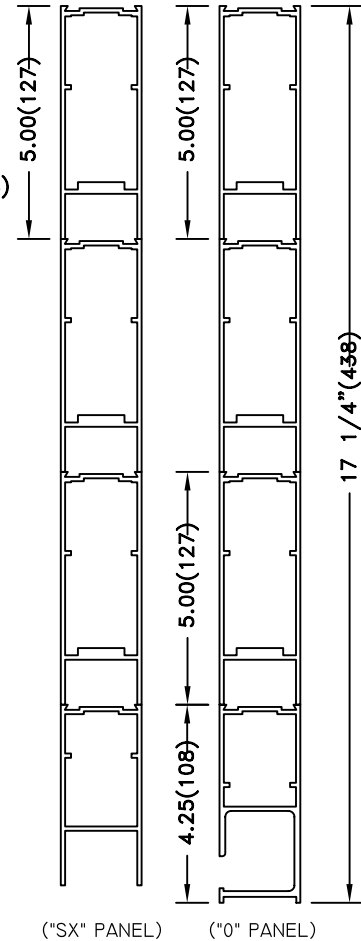

NOMINAL 18"

MEDIUM STILES AFFECT EVERY FORMULA FOR ANY GIVEN PACKAGE.
LISTED BELOW ARE FORMULAS RELATED TO MEDIUM STILE DOOR PACKAGES ONLY.

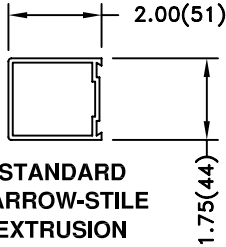

**STANDARD
NARROW-STILE
EXTRUSION**

SINGLE SLIDE - MEDIUM STILE

PACKAGE WIDTH = 2X CLEAR DOOR OPENING + 17 3/4"
CLEAR DOOR OPENING = 1/2 PACKAGE WIDTH - 9 3/8"
EMERGENCY BREAKOUT WIDTH = PACKAGE WIDTH - 10 1/2"
DOOR PANEL WIDTH = 1/2 PACKAGE WIDTH + 1/4"

BI-PART MEDIUM STILE

PACKAGE WIDTH = 2X CLEAR DOOR OPENING + 32 1/16"
CLEAR DOOR OPENING = 1/2 PACKAGE WIDTH - 16 1/16"
EMERGENCY BREAKOUT WIDTH = PACKAGE WIDTH - 17 1/2"
DOOR PANEL WIDTH = 1/4 PACKAGE WIDTH + 1 1/16"

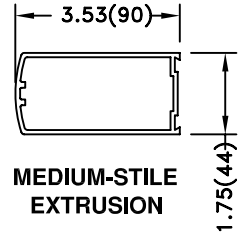

**MEDIUM-STILE
EXTRUSION**

NOTE: MEDIUM STILE DOOR PACKAGE HAS SAME TOP AND BOTTOM RAILS AS SHOWN IN TYPICAL NARROW STILE VERTICAL SECTION.

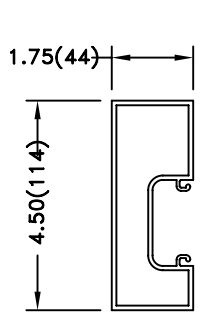

**STANDARD
JAMB-4 1/2"**

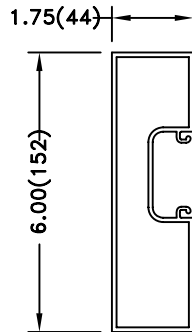

JAMB-6"

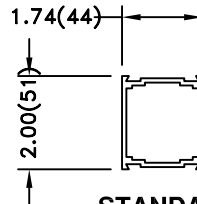

**STANDARD
2" MUNTIN BAR**

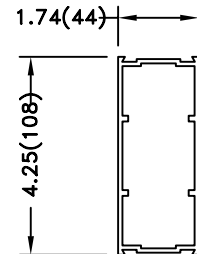

**4 1/4" EXTRUSION
MUNTIN BAR**

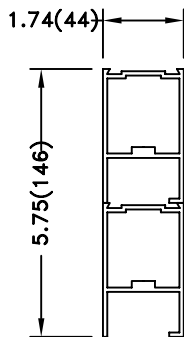

**6" NOMINAL
MUNTIN BAR**

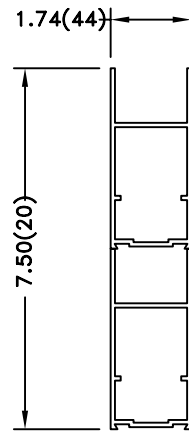

**8" NOMINAL
MUNTIN BAR**

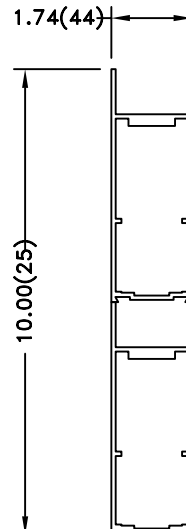

**10"
MUNTIN BAR**

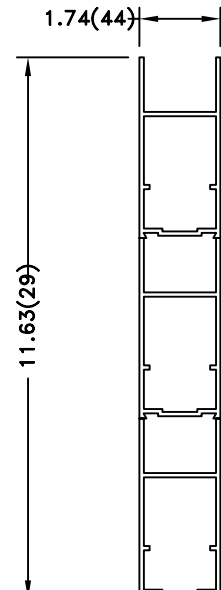

**12" NOMINAL
MUNTIN BAR**

NOTE: TOP RAIL AND STANDARD DIMENSIONS DO NOT VARY. FOR OPTIONAL BOTTOM RAILS SEE APPENDIX 1.1.D.

STANLEY

GLASS STOP EXTRUSION OPTIONS

**DURA-GLIDE
3000**

1/4" GLASS

HORIZONTAL

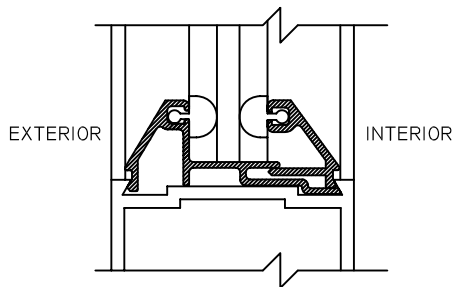

**GUTTER-BEVELED EXTRUSION
(RUNS HORIZONTALLY)**

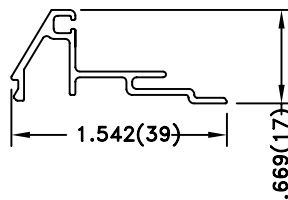

**GUTTER-BEVELED
EXTRUSION**

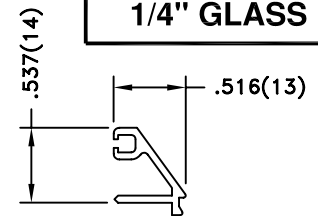

**GLASS STOP-BEVELED
EXTRUSION**

VERTICAL

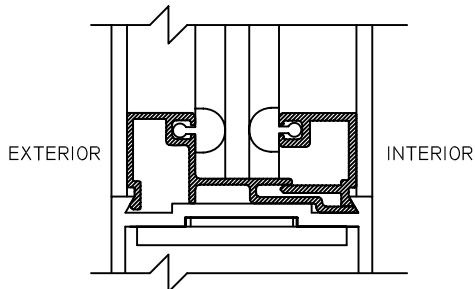

**GUTTER EXTRUSION
(RUNS VERTICALLY)**

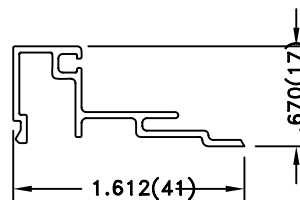

**GLASS STOP-GUTTER
EXTRUSION**

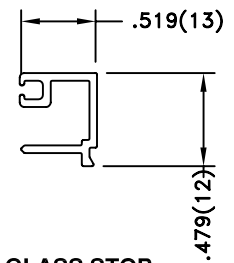

**GLASS STOP
EXTRUSION**

5/8" GLASS

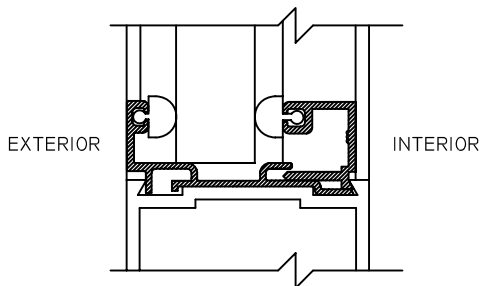

**GLASS STOP
ASSEMBLY**

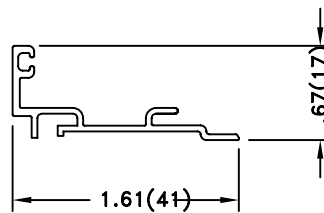

**GLASS STOP-GUTTER
EXTRUSION**

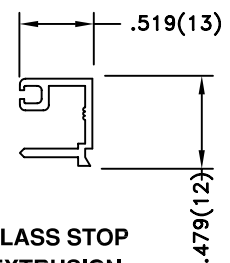

**GLASS STOP
EXTRUSION**

1" GLASS

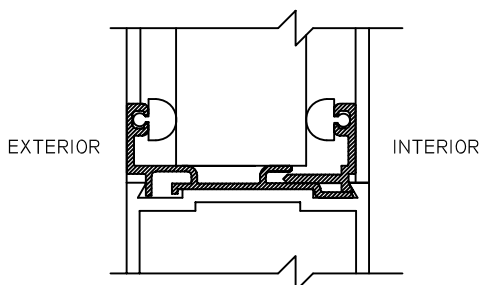

**GLASS STOP
ASSEMBLY**

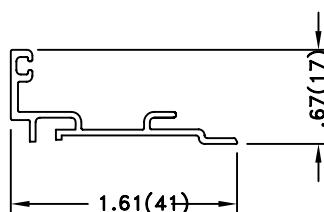

**GLASS STOP-GUTTER
EXTRUSION**

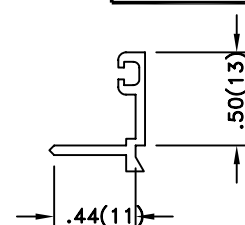

**GLASS STOP
EXTRUSION**

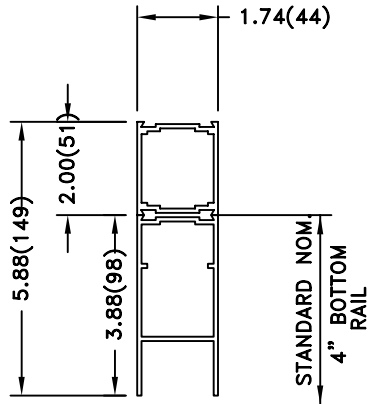

NOMINAL 6"

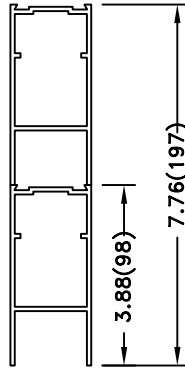

NOMINAL 8"

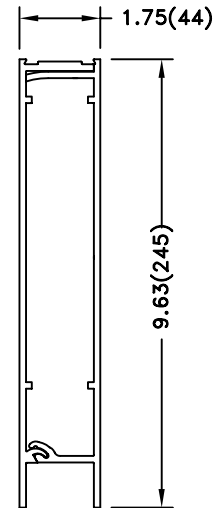

**10"
SEAMLESS**

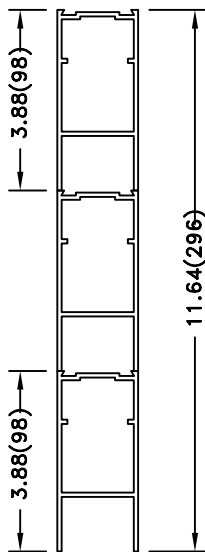

NOMINAL 12"

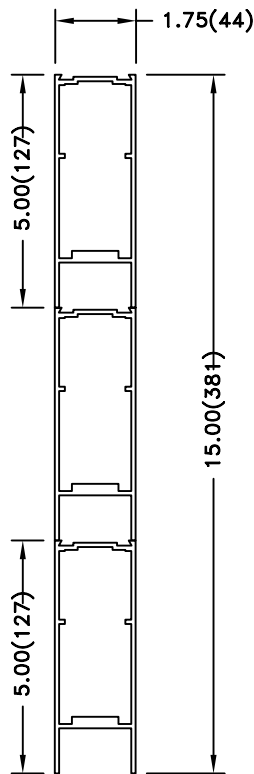

15"

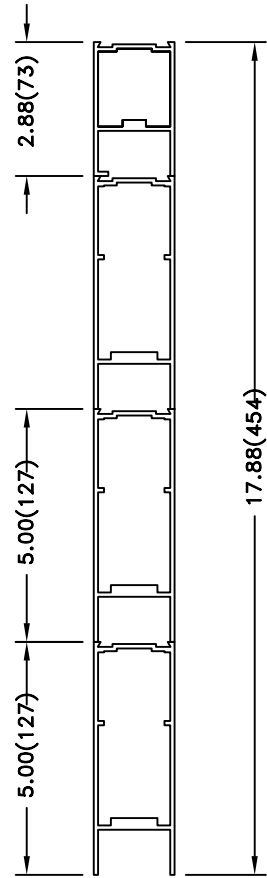

NOMINAL 18"